



925 S. Niagara Street Suite 250
Denver, Colorado 80224
Toll-Free: 1-855-885-9570
info@federalsteelsystems.com
<http://federalsteelsystems.com>

Framing Systems

RIGID FRAME or Tapered Column

The clear, unobstructed working space that the Rigid Frame or Tapered Column system provides, makes it ideal for many commercial and recreational applications. The Clear Span application permits an unobstructed floor space, which allows complete utilization of the interior building. Arenas, such as sports and agricultural buildings, aircraft hangars, and warehouse facilities are often designed as clear span rigid frame systems because of no interference from interior columns.

Rigid Frame or Tapered Column Buildings



Gable Clear Span



Single Slope Clear Span

STRAIGHT COLUMN

Straight Column systems are utilized when a clear interior space from floor to eave is required. The column-free interior (Clear Span) allows the total amount of floor space to be put to use. This design is commonly used in small office buildings, strip malls or other commercial applications. Straight Column design can be used in gabled or single slope applications.

Straight Column

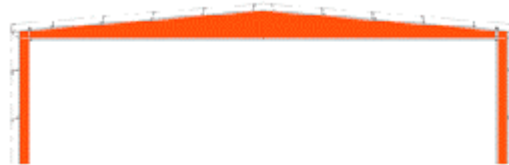

Multi-Span

The Multi-Span system is ideal when the building width is extensive or roof loads are heavy. Multi-Span design allows the building to be utilized for any industrial, warehouse or commercial applications.

Multi-Span



LEAN-TO

The Lean-To system is an efficient and economical way to expand a building. Additional space can be added without interrupting the internal operations of the existing building. The Lean-To system is easy to add and ideal for additional storage or office space.

Lean-To

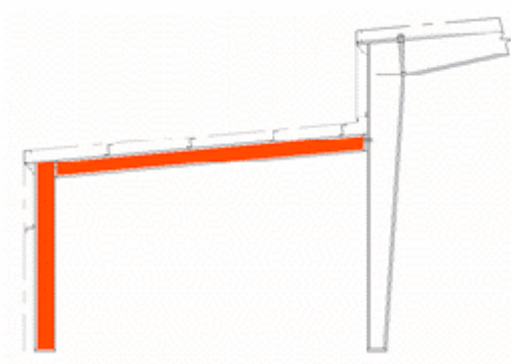

MONITOR

The Monitor or Raised Roof Barn has the center of the roof raised (pushed up) from the main roofline. The Monitor look is sometimes preferred over the standard gable due to its appearance. The center of the building or the upper portion can be used simply to emit more light and allow additional ventilation or can be used as a loft for storage.

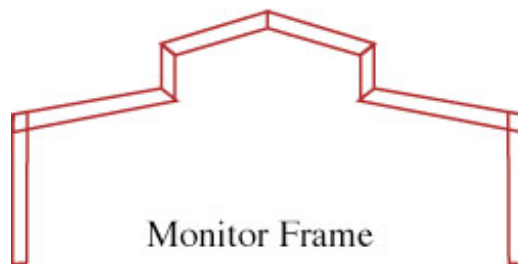



925 S. Niagara Street Suite 250
Denver, Colorado 80224
Toll-Free: 1-855-885-9570
info@federalsteelsystems.com
<http://federalsteelsystems.com>

GAMBREL

Gambrel or Dutch Style building has the roof built with a double slope on each side of the roof structure with the lower slope having a steeper roof pitch than the upper slope. This allows for attic or storage space. Example is a horse barn that has a Gambrel roof, the upper area provides for hay storage. This building style is also used as a residential facility.

